

The #11912 Precision Honing / Sharpening Guide is a lightweight honing guide for chisels and plane irons. Easy to set up, fast and accurate! Follow these steps for basic operations of your guide!

Overview and getting familiar with your guide!

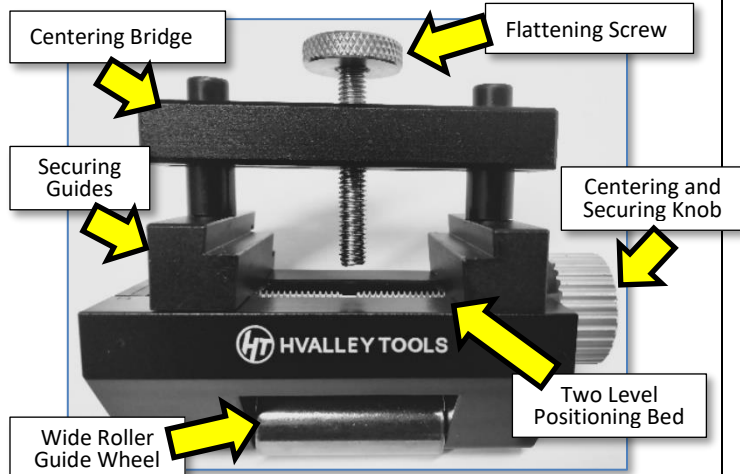

As you begin using your guide, leave the two bolts on top of the Centering Bridge sufficiently loose so that it will easily slide side-to-side.

Now, you are ready to insert your chisel or plate iron into the guide (remember, logo side!).



Loosen the Flattening Screw to allow for enough insertion clearance.

Spread the Securing Guides by turning the Center and Securing Knob until they are wide enough for your chisel or plane iron.

Insert your chisel, flat side UP or bevel side down, from the rear of the guide (logo side).

Adjust the Centering Bridge till the Flattening Screw is center over your chisel / plane iron.

Tighten the Securing Guides and Flattening screw until they are snug.

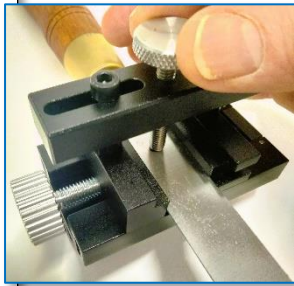

Now, you can either match the current angle of your chisel / plate iron by adjusting its length or attach the angle gauge for a more precise angle.

To attach the angle gauge:

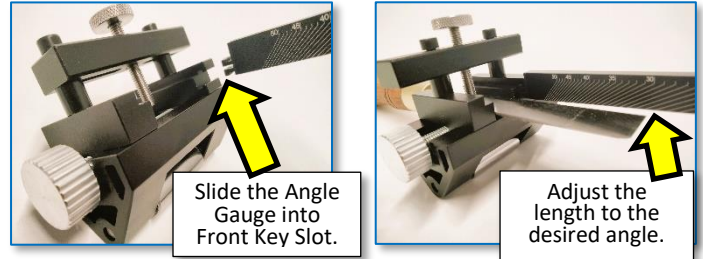

Once you are satisfied with the angle position, tighten the Flattening Screw and Centering and Securing Knob!

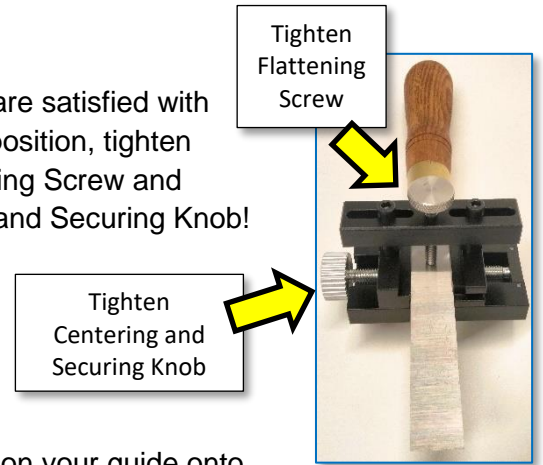

Now, position your guide onto your sharpening stone, depending on the width, length and wear on your stone, you can decide where to align it!

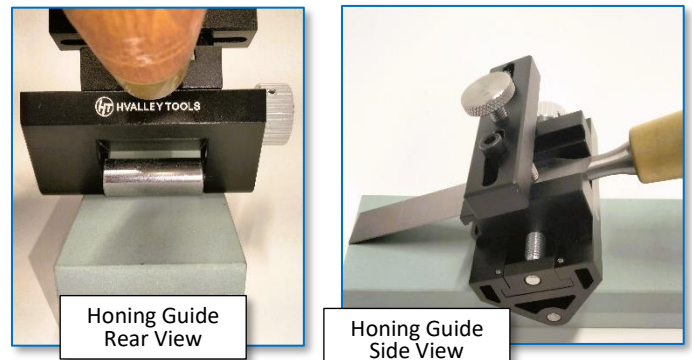

You are now ready to begin sharpening and honing!

From here on, your sharpening technique is what your preferences are. Need help? Please ask us!